



Moonfleet Manor Hotel
Fleet Road, Weymouth, DT3 4ED
01305 786948
events@moonfleetmanorhotel.co.uk
www.moonfleetmanorhotel.co.uk
36 rooms

BY ROAD

Moonfleet Manor Hotel offers free parking for up to 100 cars.

Distance from major UK cities

Bournemouth	40 miles	1 hour
Southampton	65 miles	1 hour 45 mins
London	140 miles	3 hours

BY TRAIN

Nearest station	
Weymouth Station	15 mins by taxi
London Waterloo to Weymouth Station	3 hours
Southampton Station to Weymouth Station	1 hour 30 mins
Bournemouth Station to Weymouth Station	1 hour

BY AIR

Exeter Airport	1 hour 20 mins by taxi
Southampton Airport	1 hour 40 mins by taxi

A helipad is available at the hotel, please call for landing information.



Moonfleet Manor

JURASSIC COAST

Moonfleet Manor's Georgian design and effortless interior flair make it one of Luxury Famil Hotels most inviting meeting spaces. With panoramic views of the unspoilt Dorset countryside, overlooking Weymouth's Chesil Beach, the location is ideal for focused, distraction free meetings.

Delegate Packages

Day Delegate Package* – £50pp

- Meeting room hire
- Stationery equipment (pencils, paper, flipchart)
- Bottled water
- Tea and coffee on arrival
- Mid morning refreshment break
- Two course lunch
- Afternoon pick me up break with refreshments

24 Hour Package* – POA

As day package above plus:

- Three course evening meal
- Overnight accommodation
- Full English Breakfast
- Full use of spa leisure facilities. (Treatments can be arranged at extra cost)

Half Day Package* – £35pp

- Meeting room hire
- Bottled water
- Two servings of tea and coffee
- Stationery equipment (pencils, paper, flipchart)
- Two course lunch

*Minimum numbers apply to all packages, please enquire when booking.

Working lunches, working breakfasts, exclusive hire and hourly rates are all available upon request.

Complimentary technical equipment available

- WiFi
- Smart TV for projection

Team Building Activities

Moonfleet Manor has extensive grounds perfect for a wide variety of unique and exciting team building activities. There is also plenty of indoor space for any grey rainy days. Please call to discuss your specific requirements and the events team will be happy to advise you on your activity choices and arrangements.

On-site

- Orienteering*
- Archery*
- Snooker
- Squash
- Tennis
- Skittles

Off-site

- Sailing
- Horse Riding
- Golf
- Hiking the South West Coastal Path

*Request details of external partner when calling to arrange these activities.

Major attractions nearby

Weymouth & Portland National Sailing Academy | Sealife Centre
 Monkey World | Tank Museum | Abbotsbury Swannery

Restaurant

The Restaurant is open for breakfast, lunch and dinner.

Service Hours

Breakfast: 7.30am – 10am
 Lunch: 12pm – 2pm
 Dinner: 6pm – 9pm

Leisure Facilities

Indoor swimming pool open 8am – 5.45pm and pamper treatment rooms open 10am – 6pm.



Moonfleet Manor

JURASSIC COAST

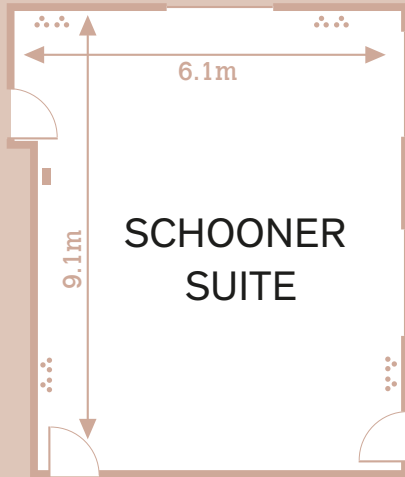

KEY

-  Power socket
-  Light switch

MAIN HOUSE

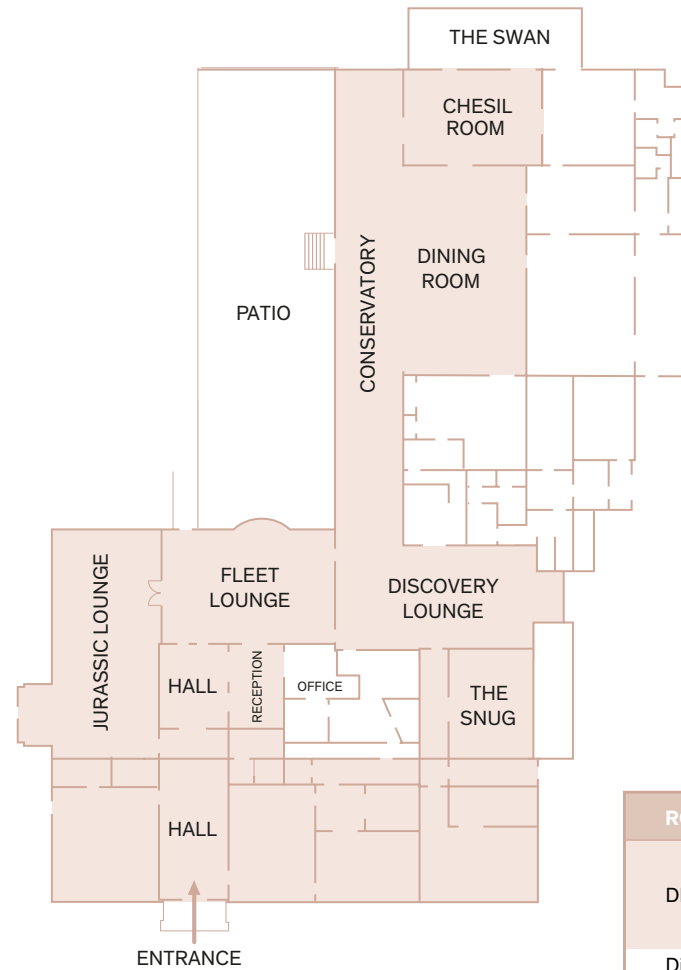

SEPARATE ANNEX



ROOM NAME	SCHOONER SUITE
DESCRIPTION	The Schooner Suite is located in a separate annexe and offers a formal privat environment for meetings. An extensive range of breakout areas are located nearby.
Dimensions	9.1m x 6.1m
Dining	N/A
Boardroom style	20
Theatre style	50
U-shape	32
Cabaret	30
Drinks reception	N/A
Speakers	-
TV output	-
Natural daylight	✓
No.of double sockets	4
Floor	Separate Annexe – first floor
Ceiling height	Standard

Drawings not to scale.